



WESTWOOD
VILLAGE



WELCOME

to *your* village





**“The Earth
has music
for those
who listen.”**

William Shakespeare



CONTENTS

5

A Community
Inspired by History

13

Your Connections

21

Westwood
Park

7

You'll Enjoy Every
Moment

15

Welcome to
Westwood Village

23

Harmonious Homes
Designed For You

9

Live and Learn

17

A Master-Planned
Community

25

Step Inside Your
Dream Home

11

Convenient
Nature at Your Door

19

Westwood
Pond

27

Meet Your Builder:
Cachet Homes

CANAL BRIDGE

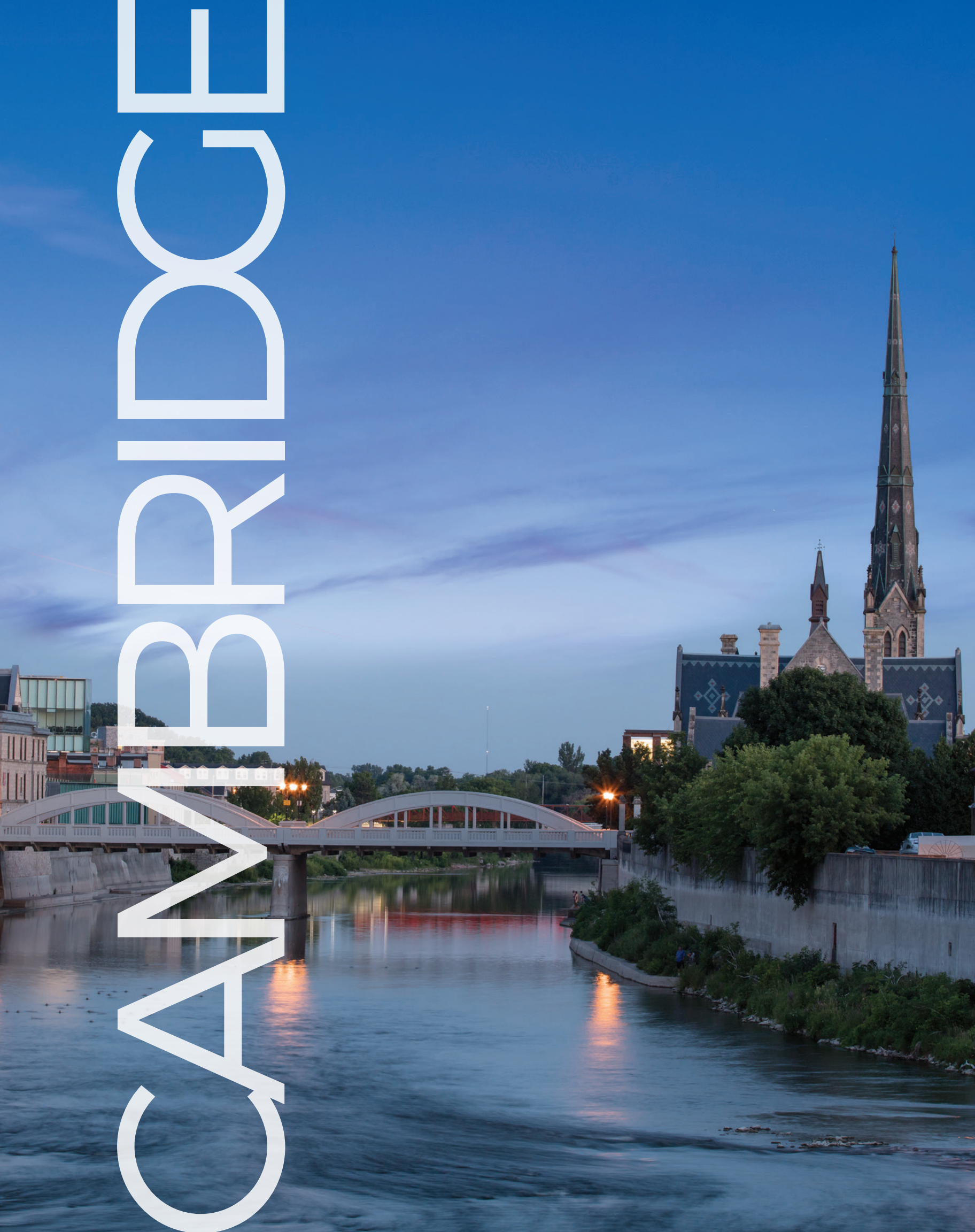



A COMMUNITY INSPIRED BY HISTORY

Years ago, stone masons constructed many of the limestone and granite buildings now occupied by shops, restaurants, and businesses in Cambridge. This history has been thoughtfully woven into the design of Westwood Village, with a unique opportunity to be a revered gateway to the City of Cambridge. Extensive effort and creativity went into integrating this community with the surrounding natural, rural and urban lands.

A city in the Regional Municipality of Waterloo, Cambridge has carved out its own identity as a new city with a rich history. Formed in 1973 by the amalgamation of Galt, Preston, Hespeler and a small portion of surrounding townships, Cambridge is located at the confluence of the Grand and Speed Rivers. Cambridge is thriving and becoming more and more cosmopolitan as families find homes, robust employment opportunities and vibrant communities that enhance every lifestyle.





YOU'LL ENJOY EVERY MOMENT

Downtown Cambridge is just minutes from Westwood Village. Walking along the downtown streets, you will enjoy the historic stonework that defines each building. Take in some of the many arts and cultural exhibitions, perhaps starting at the Fashion History Museum with some garments dating back to the 1600s, or visit one of the city's three art galleries: Queen's Square Gallery, Design at Riverside Gallery and Preston Gallery, each with their own focus and special collections.

Downtown Cambridge is a vibrant community waiting to be discovered. At every corner you will find an homage to the city's rich history with a new modern twist from the trendy shops, cafes, restaurants, and craft breweries that now occupy downtown Cambridge.

Living in Cambridge provides a rich and fulfilling lifestyle. In addition to a multitude of urban amenities, Cambridge is also home to vast parkland and greenery. Canoe or kayak your way along the rivers, or bike or stroll through the winding nature trails. There's so much to explore!





LIVE AND LEARN

Cambridge is an attractive place to live. As part of the Waterloo Region, which continues to grow and thrive, you'll find top notch educational and career opportunities abound.



MOFFAT CREEK PUBLIC SCHOOL



CONESTOGA COLLEGE

OUTPACE THE COMPETITION

Cambridge is one of the fastest growing and strongest economic areas in Canada. With a strong connection between the academic institutions and the business community, there are endless opportunities for cooperative education, recruitment, contracts, research, joint-support programs and the retention of a high-quality local workforce.

There are many educational opportunities in the City of Cambridge, including:

- Access to several nearby institutes of higher education including the **University of Waterloo, Wilfred Laurier University and the University of Guelph.**
- Continuing education programs for adults to upgrade and add skills at Conestoga College and other institutions.
- 40 elementary and 7 secondary Catholic and public schools.



UNIVERSITY OF WATERLOO



WILFRED LAURIER UNIVERSITY



UNIVERSITY OF GUELPH

DID YOU KNOW?

- The region is recognized as a magnet for design and imagination with many tech companies choosing to locate here.
- Cambridge is part of one of Ontario's fastest growing and economically prosperous regions.
- Quickly being recognized as one of the North America's "tech centres," Cambridge continues to attract start-ups and high-tech firms from around the globe.





NATURE

at your door

NATURE'S RICHES, YOUR REWARD

Westwood Village is a proud neighbour of the rare Charitable Research Reserve. This urban land trust and environmental institute in Waterloo Region/Wellington protects almost 1,000 acres of highly sensitive lands. Since its inception, rare has taken care of the land on behalf of the community and shares its passion for conservation, research and education.

Westwood Village is a one-of-a-kind community where the preservation of nature is a priority. Together, we will steward these lands with respect for generations past, present and those to come. We will preserve trees more than 250 years old, 24 habitat types and the magnificent pre-settlement landscapes that thrive around Westwood Village.



LEAVE THE ROAD, TAKE THE TRAILS

Cliffs & Alvars Trail System:

- ECO Trail 230m,
- Osprey Tower Trail 750m,
- River Trail 1.93km,
- Woodland Trail 750m,
- Alvar Trail 280m,

Indian Woods & Thompson Tract Trail System:

- Grand Allée 1.12km,
- Maple Lane Trail 620m,
- Deer Run Trail 970m,

Butterfly Trail and Pavilion

- Butterfly Interpretive Loop 930m





YOUR CONNECTIONS

HIGHWAYS & BIWAYS

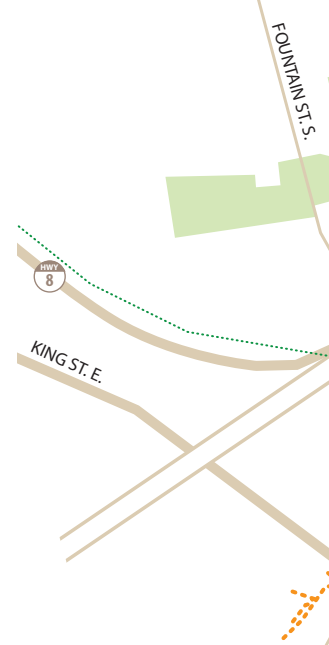

WHAT'S TRENDING?

134,000+

People call Cambridge home

100+

Parks

70km

Trails, with half along the banks of the Grand and Speed Rivers

35

Soccer fields

20

Golf courses

13

Ice surfaces

7

Public pools

DINING

- 1 Blackwing Coffee Bar
- 2 Cambridge Mill
- 3 The Black Badger
- 4 Galt Juice Company
- 5 Melville Café
- 6 My-thai
- 7 Barnacle Bills
- 8 Local Tap Room
- 9 Red Basil Vietnamese
- 10 Monigram Coffee Roasters
- 11 E.V.O. Kitchen
- 12 Latinoamerica Unida
- 13 Grand River Brewing
- 14 Dee's Bakery
- 15 Sugar Daddies Bakery
- 16 Elixir Bistro

RECREATION & ENTERTAINMENT

- 1 Hamilton Family Theatre Cambridge
- 2 McDougall Cottage Historical Site
- 3 George Hancock Pool
- 4 Dickson Centre
- 5 Fire Hall Museum & Education Centre
- 6 Galt Arena Gardens
- 7 Cambridge Tennis Club
- 8 John Dolson Community Centre
- 9 Galaxy Cinemas
- 10 Victoria Park Tennis Club
- 11 RARE trails
- 12 Play with Clay

EDUCATION

- 1 Blair Rd. Public School
- 2 St. Augustine Catholic School
- 3 Highland Public School
- 4 St. Andrew's Public School
- 5 Stewart Avenue Public School
- 6 Chalmers St. Public School
- 7 Southwood Secondary School
- 8 Tait Street Public School
- 9 Avenue Rd. Public School
- 10 Central Public School
- 11 Moffat Creek Public School

SHOPPING

- 1 Shoppers Drug Mart
- 2 Food Basics
- 3 Southworks Antiques
- 4 Cornerstone Home Interiors
- 5 **Westgate Centre**
- 6 Baba Bazar & Al Madina Halal Me
- 7 Cambridge Centre
- 8 **SmartCentres Cambridge**



Cambridge GO Bus Stop

Walking Trails



Cambridge Transit



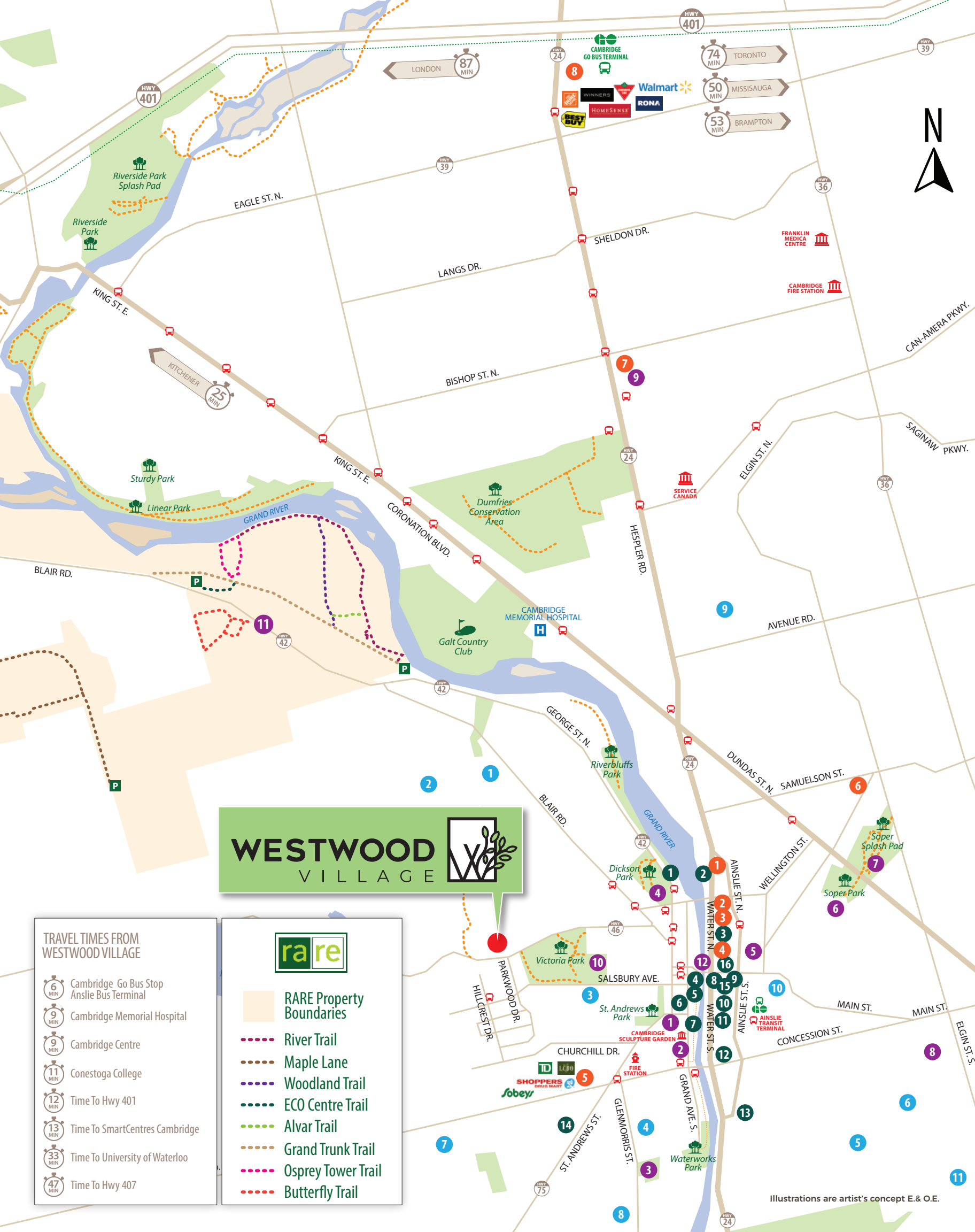









WESTWOOD VILLAGE

TRAVEL TIMES FROM WESTWOOD VILLAGE

6 MIN	Cambridge Go Bus Stop Anslie Bus Terminal
9 MIN	Cambridge Memorial Hospital
9 MIN	Cambridge Centre
11 MIN	Conestoga College
12 MIN	Time To Hwy 401
13 MIN	Time To SmartCentres Cambridge
33 MIN	Time To University of Waterloo
47 MIN	Time To Hwy 407

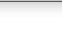

-  RARE Property Boundaries
-  River Trail
-  Maple Lane
-  Woodland Trail
-  ECO Centre Trail
-  Alvar Trail
-  Grand Trunk Trail
-  Osprey Tower Trail
-  Butterfly Trail

Illustrations are artist's concept E.& O.E.



WELCOME TO WESTWOOD VILLAGE

Explore endless trails, scale pedestrian
bridges, skip rocks in the pond and
discover beauty all around you.

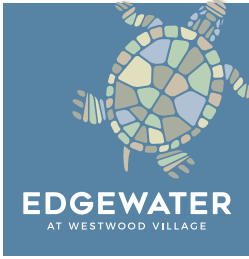

SLOW AND STEADY

In Edgewater, you'll spot the colourful Midland Painted Turtle. These native North American turtles live in slow-moving fresh waters. See their colourful "painted" shells while you stroll the trail encircling the Community Pond.

LEAP INTO VILLAGE LIFE

You're just a hop, skip and a jump away from the peaceful Community Pond when you live in the Parkside neighbourhood. Just like the Northern Leopard Frog, you will take that leap into village life and never look back.



STUNNING TO SEE

In the Mariposa neighbourhood, you are central and its strikingly beautiful like its namesake. If you're lucky, you'll catch a rare glimpse of the endangered Baltimore checkerspot butterfly while enjoying a stroll along the trails.

FOLLOW YOUR INSTINCT

Foxhollow is the one neighbourhood hugged by two of the community's ponds. Like a stealthy fox, you'll get to know your way around the village using pathways and pedestrian bridges to connect to trails and parks just beyond your front door.

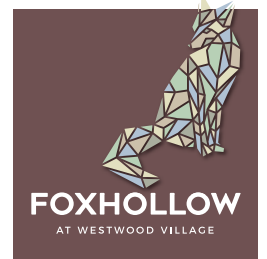

A MASTER-PLANNED COMMUNITY OF SEVEN DISTINCT NEIGHBOURHOODS



INTRIGUING BEAUTY

From your front porch in the Summerside neighbourhood, it's easy to spot the colourful Canada Darner Dragonfly taking flight. These dragonflies are seen between June and October. Take a short stroll around the Community Pond and watch as they whiz around the water's edge.

WISE MOVE

Just beyond the village's entrance is Windsong, a neighbourhood nestled alongside the natural lands. Your lush forested view might just include a sighting of a majestic owl in flight or perched on a branch high above.



Hop on over

In the Fairfields neighbourhood, you're closest to the joyful sounds emanating from the Future Community Park. Don't be surprised if you see a bunny or two hop by. Follow them down the pathway through the park and you'll connect to trails that will take you even further afield.



N



Wayfinding Feature

Trailhead
Community Walking Trails

Westwood Pond

NEWMAN DRIVE

ROSEVILLE ROAD

EDGEWATER
AT WESTWOOD VILLAGE

SUMMERSIDE
AT WESTWOOD VILLAGE

MARIPOSA
AT WESTWOOD VILLAGE

SEVEN NEIGHBOURHOODS EMBRACED BY NATURE



JOGGING
5.6 KM



CYCLING
5.6 KM



WAYFINDING
FEATURES



REST
AREAS

You will love calling Westwood Village home. Stroll down tree-lined streets, kids zipping around on their bikes, and friendly waves from neighbours as you pass by. Westwood is the community dreams are made of.



PARKSIDE
AT WESTWOOD VILLAGE



FAIRFIELDS
AT WESTWOOD VILLAGE



WINDSONG
AT WESTWOOD VILLAGE



FOXHOLLOW
AT WESTWOOD VILLAGE

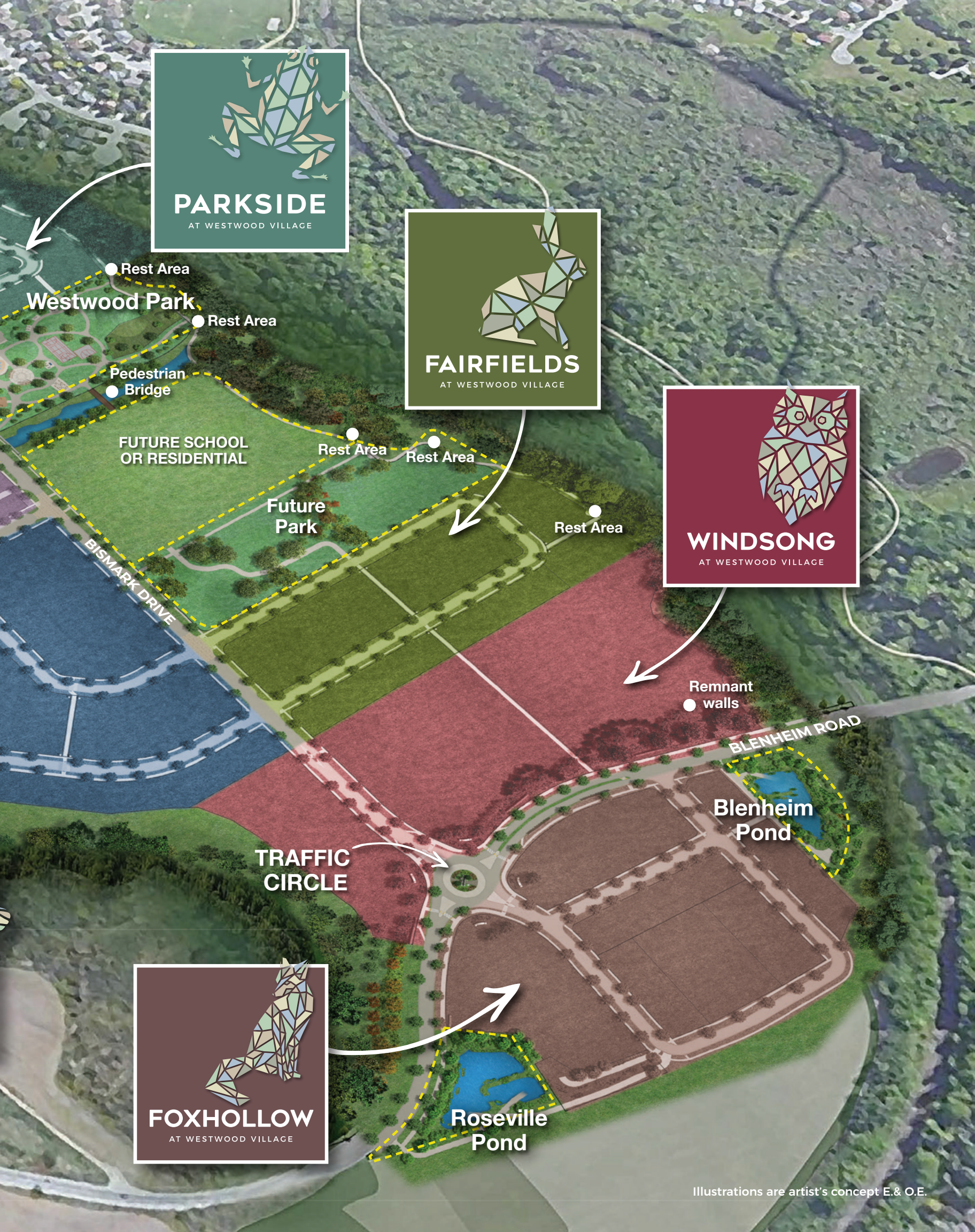

WESTWOOD



POND



Just steps from your front door, you will find Westwood Pond. Surrounded by acres of wetlands, woodlands and parklands, Westwood Village's seven distinct neighbourhoods encircle their very own pond, the perfect place to enjoy an evening stroll.





WESTWOOD PARK



Community Walking Trails

Throughout Westwood Park find walkways, trails, playgrounds, and fitness stations.



Community Splash Pad

Enjoy hot fun in the summer at the Westwood splash pad and play area.



Westwood Park

In the northern part of Westwood Village, there is a special place for picnics, playing ball and flying kites. Imagine a splash pad, an off-leash dog park with green space to spare. The brand new Westwood Park will be enjoyed by all and it has been made possible by Hallman Construction.



Park is subject to municipal approvals. Illustrations are artist's concept E.& O.E.



HARMONIOUS HOMES DESIGNED FOR YOU



Stephen Hunt
Principal - Hunt Design Associates Inc.

This is a signature community and we are proud to be working with Cachet Homes once again to design homes with the right architecture, cohesiveness and lifestyle for you. As a sophisticated buyer, we know you appreciate good design and elements that enhance your lifestyle.

Here in Westwood Village you have a beautiful selection of new home designs to suit your needs. This community with seven neighbourhoods, each with their own unique identity, respects nature and enhances the enjoyment of nature and the outdoors.

Cachet presents a variety of distinctive homes with traditional and contemporary architecture. The styles will complement each other by the use of harmonious roof forms, porch elements and materials used in warm earth-tones.

The homes have open and flexible floor plan concepts, combined with large windows which allow plenty of natural light. In keeping with today's contemporary lifestyle needs, the homes are designed around the kitchen, always considered the heart of the home. Many designs include flexible spaces that may be used for working remotely.

1 Dark metal seamed roof

2 Large picture windows

3 8' front door

4 Premium siding colours

5 Premium brick colours

6 Contemporary colour palettes

7 Contemporary garage door styles



Illustrations are artist's concept E.& O.E.



STEP INSIDE YOUR DREAM HOME



- 1 9' Ceilings on main level
- 2 Pull-out spray faucet
- 3 Stainless steel undermount sink
- 4 USB integrated outlet in kitchen
- 5 Granite or quartz countertop
- 6 Breakfast bar, as per plan
- 7 Extended height upper cabinets
- 8 Hardwood on main level - natural varnished finish (excluding tiled areas)
- 9 Contemporary baseboards and casing

Additional features include:

- California knockdown ceiling on main and upper level (smooth ceilings in kitchen, laundry room and all bathrooms)
- Glass shower enclosure with chrome trim in master ensuite
- Cold cellar

All finishes are as per applicable plan and/or elevation. Finishes available from vendors standard samples, subject to change without notice. Illustrations are artist's concept. Refer to 'Schedule A' for features and finishes specifications. E. & O.E.



Chefs kitchen with a sizeable breakfast area and convenient servery

Spacious living room for family gatherings

Dining room perfect for all those special occasions

Generous Covered Porch

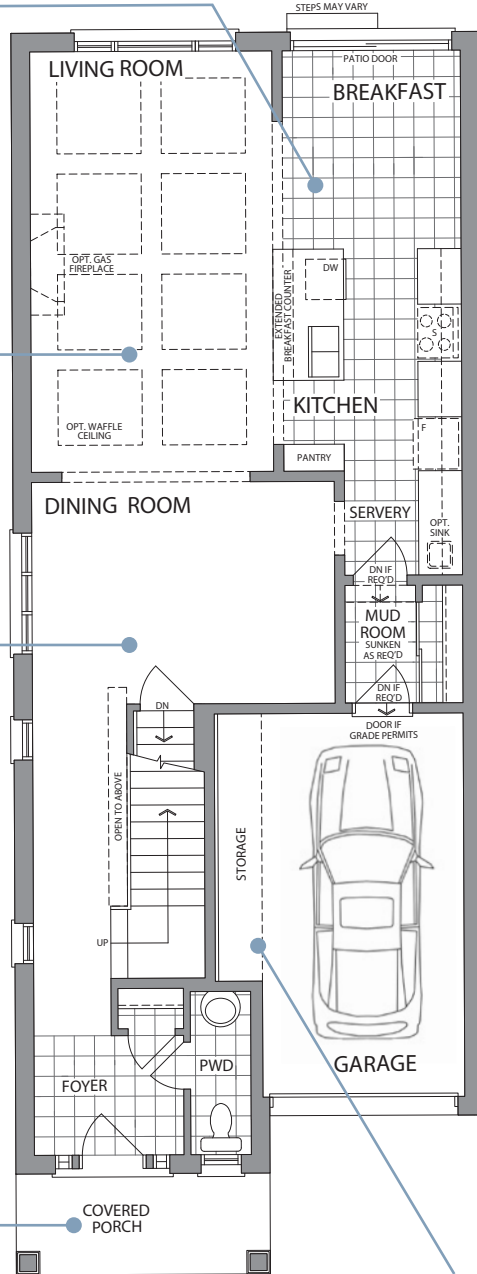

CORONATION 30-07
MAIN LEVEL - ELEV. A

Bonus storage area in garage with convenient Mudroom

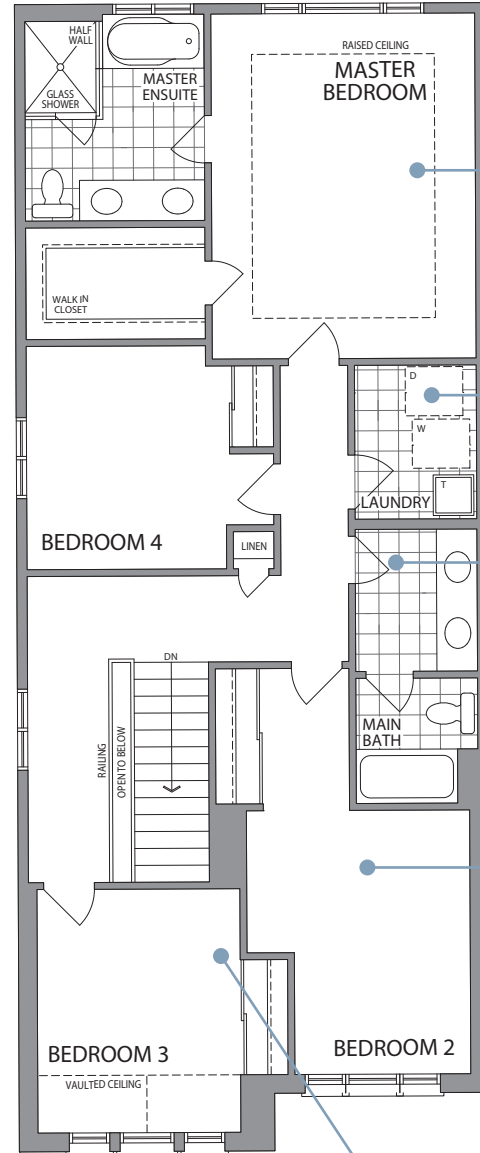

CORONATION 30-07
UPPER LEVEL - ELEV. A

Master retreat pampers you with a spa-like 4 piece ensuite and large walk in closet

Convenient second floor laundry room

Double sink vanity for those busy mornings

4 generous bedrooms allows plenty of space for a growing family

The extra bedroom can be used for guests or a useful home office





CREATING VISIONARY COMMUNITIES SINCE 1981

Founded in Markham, Ontario in 1981 the Cachet Group of Companies has earned an enviable reputation as the developer and builder of master-planned communities across southern Ontario. It's a reputation built on an unrelenting commitment to innovative architecture, superior craftsmanship, and outstanding customer-care. They believe three symbiotically interconnected principles explain their ongoing success: Integrity, Vision and Execution.

For everyone on the Cachet team, demonstrating Integrity in all of their relationships is a core business tenet. Reputations aren't built in a day, but after four decades in business Cachet Homes, and its sister company Cachet Developments, have a track record of ongoing sustained achievement. Among the many awards and distinctions that have recognized the company's commitment to excellence is the BILD Association Home Builder of the Year Pinnacle Award. It's the industry's biggest prize, honouring the recipient's dedication to quality, service and customer commitment.

The first Cachet home was built in Unionville's prestigious Cachet Country Club neighbourhood four decades ago, and from their perspective homebuilding in the GTA was forever changed. Among the qualities that set them apart is their belief that they are not just building exceptional homes, they are building exceptional communities.





Cachet is a fully integrated development firm that is hands-on over a process that starts with site selection and urban planning. Quite simply it's a comprehensive vision of real-estate development with outstanding residential communities across southern Ontario and beyond. Among them, to name just a few, are Brampton's Credit Ridge and Riverstone Golf and Country Club, Mississauga's Cachet Homes and Manors, Symphony Place, The Elements of Thornhill Woods, Cachet Beamsville, Cachet Orangeville, Cachet Grand Valley, Myers Manors, Cachet Bradford and Mount Hope.

These projects have exceeded all expectations because of Cachet's final core principle: Execution. They are committed to working with top-notch industry professionals to ensure that all aspects of the development and construction process set industry benchmarks for excellence, quality and innovation. The Cachet team has built its outstanding reputation on being an industry innovator in design, urban planning, construction and customer care. It's a legacy they're committed to upholding and enhancing.



YOUR VILLAGE AWAITS

Westwood Village is the community
dreams are made of. Encircled by nature,
you will love calling it home.
You will live your best life here and make
memories to last a lifetime.

CACHET

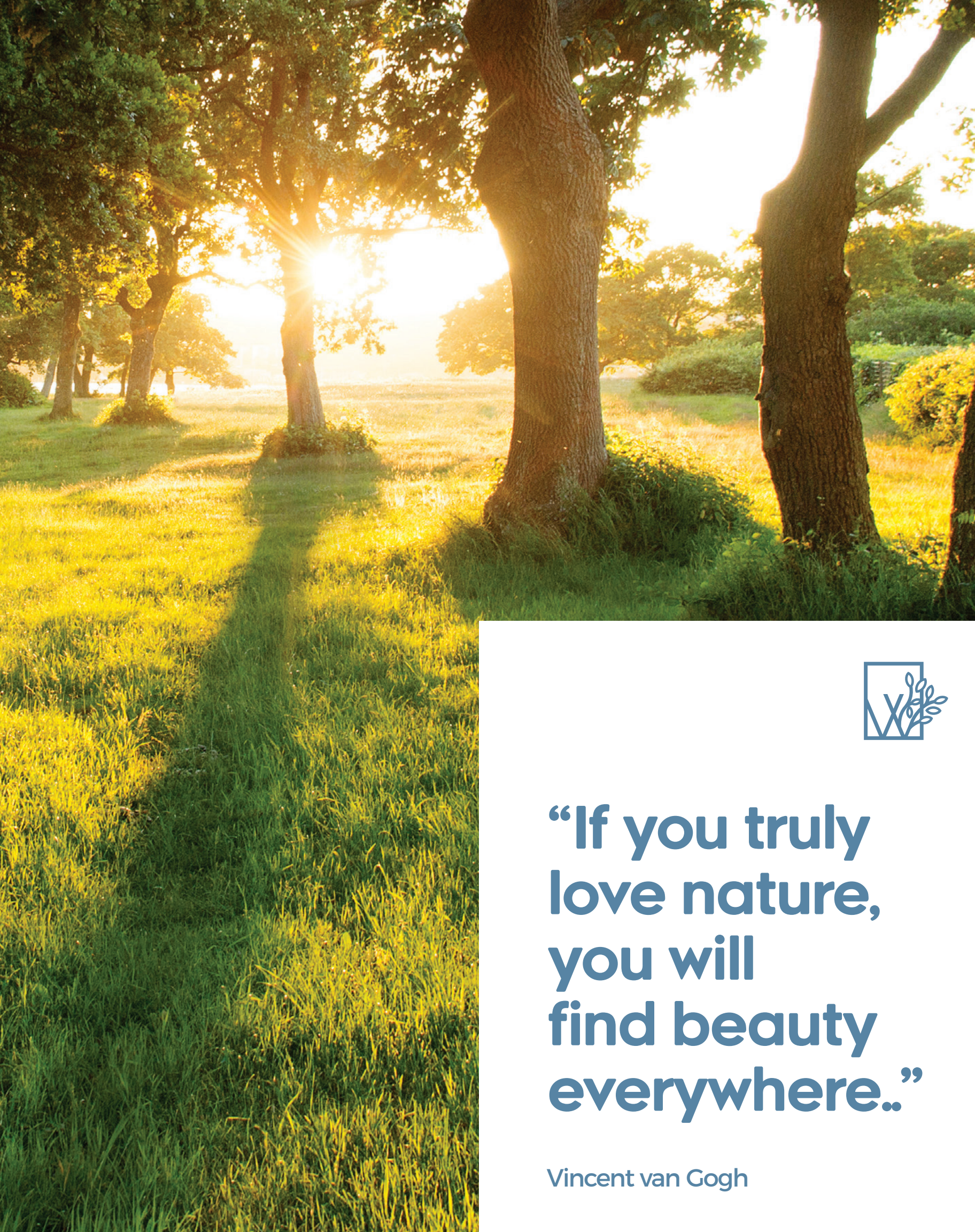

**“If you truly
love nature,
you will
find beauty
everywhere..”**

Vincent van Gogh

WESTWOODLIFE.CA

