



BLOOR STREET

PROPOSED FUTURE MEDIUM DENSITY RESIDENTIAL

PROPOSED FUTURE MEDIUM DENSITY RESIDENTIAL

STINSON CRESCENT

PROPOSED MUNICIPAL PARK (TRAILWAYS, WALKWAYS, PLANTING, LIGHTING AND FACILITIES ARE NOT YET DETERMINED)

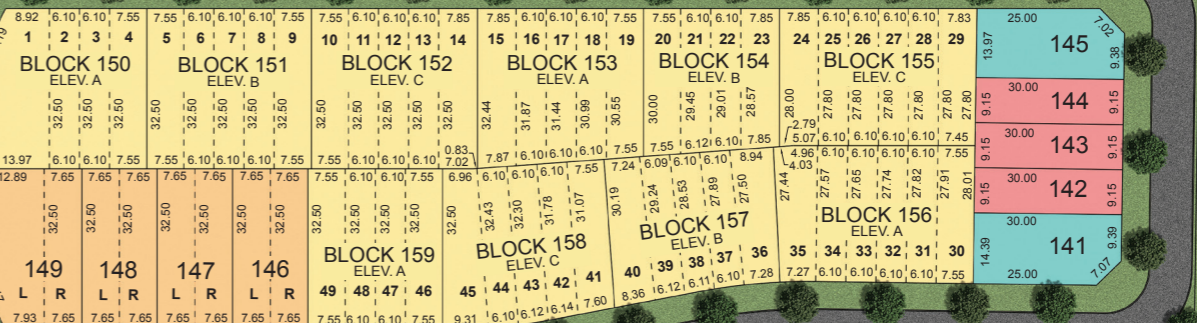

STINSON CRESCENT

GRANVILLE DRIVE

DONALD CAMERON CRESCENT

RACKHAM LANE

BACON STREET

TRULLS ROAD

- TOWN DESIGNS
- SEMI DESIGNS
- 30' DESIGNS
- 36' DESIGNS
- 40' DESIGNS

OPEN SPACE

PROPOSED MUNICIPAL PARK (TRAILWAYS, WALKWAYS, PLANTING, LIGHTING AND FACILITIES ARE NOT YET DETERMINED)

EXISTING RESIDENTIAL

EXISTING RESIDENTIAL

SERVICING BLOCK

ROAD CLOSED UNTIL FUTURE DEVELOPMENT IS COMPLETE

PROPOSED FUTURE RESIDENTIAL

PROPOSED FUTURE RESIDENTIAL

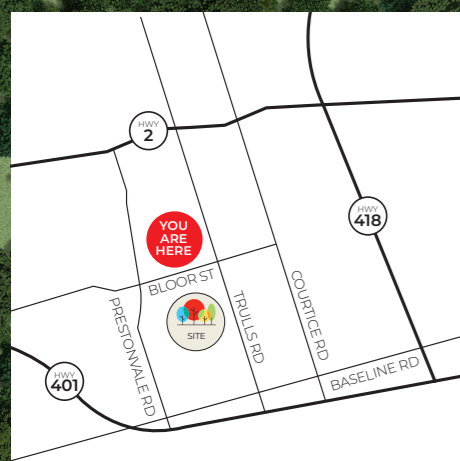

Landscaping is conceptual and final landscaping may vary from that shown on the plan. E. & O.E. 02/24